











- LEGENDA**
-  MEDAGLIONE FIOCCO CM 60
 -  MEDAGLIONE CAMPANA CM 60
 -  STELLA CM 30X30
 -  STELLA CM 60X60
 -  FIOCCO CM 60
 -  TIRANTE
 -  ALBERO LUMINOSO
 -  GHIRLANDA
 -  SFERA

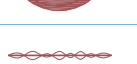

Sezione BB - Claustro Fratelli Casello

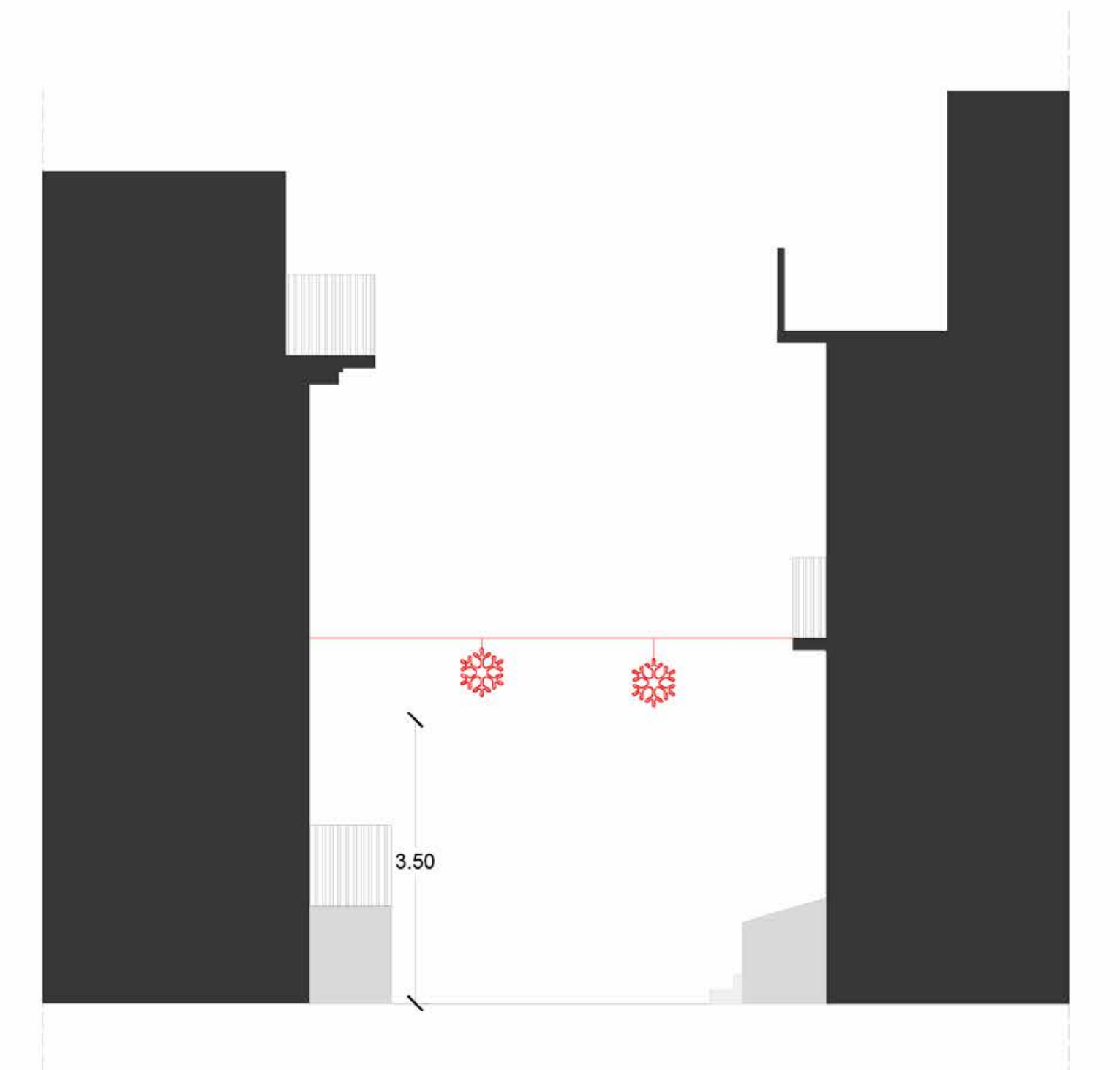
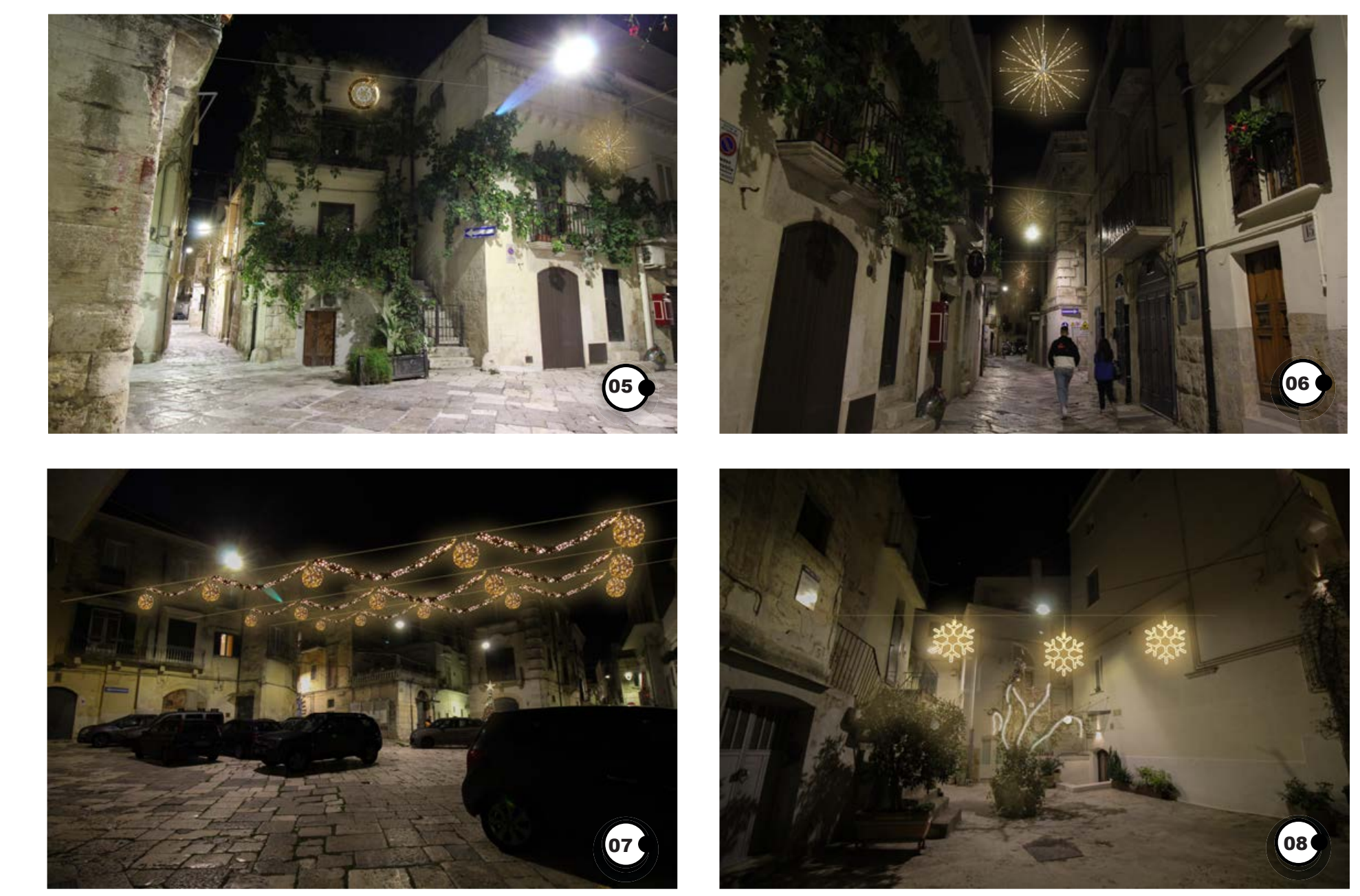

CITTA' DI ALTAMURA
 Città Metropolitana di Bari
 Settore Servizio Cultura e Turismo



PROGETTO ESECUTIVO
 PROGETTAZIONE LUMINARIE ED ALLESTIMENTI NATALIZI

Stato di progetto - Area 2

arch. Pasquale Iacovone

dott. Bernardino Galeone

dott. Arrigo Melodia

| | | | |
|--------------|-------|------|------------|
| data | scala | note | disegno n° |
| ottobre 2023 | 1/500 | | TAV. 3 |